

# Partial Extraction Therapy Kit

- Socket Shield Technique
- Pontic Shield Technique
- Root Submergence Technique

## Partial Extraction Therapy Kit

The Partial Extraction Kit has been developed specifically to make the Partial Extraction Therapy Techniques more achievable. The step by step process helps to standardize the procedure to enable faster and more predictable results. The development of the kit was made possible through research which highlighted the complications associated with the techniques.

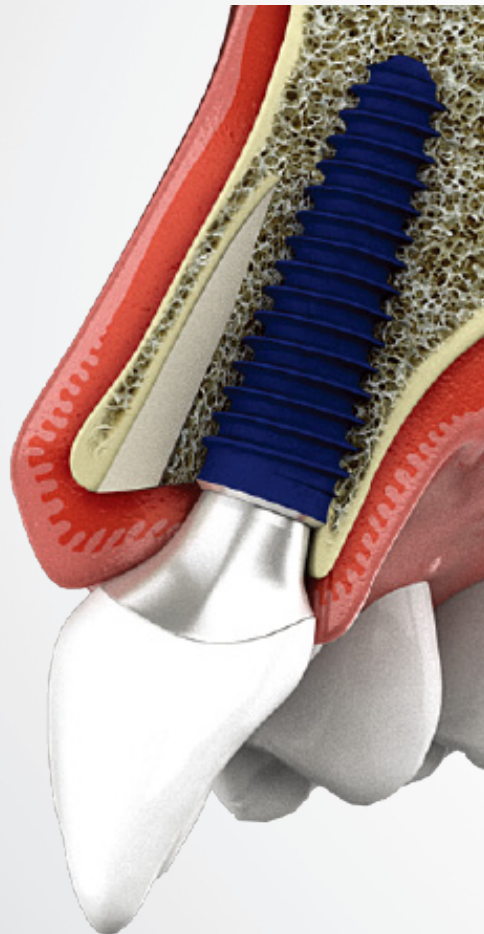

### Ideal soft tissue healing over the shield

- Allows fast and easy reduction of the roots
- Reduce treatment time and achieving predictability.
- Main complications associated with socket shield and pontic shield
- Specific drills that enable the simple reduction of the shield without damage
- Creates the prosthetic space necessary for ideal soft tissue healing over the shield
- The large round diamonds are ideal for both socket shield as well as Root Submergence Technique



➤ **No. 1 Lance Drill**  
Initially to drill the apex of the root. The depth stopper is used to set the length of the lance drill



➤ **No. 2 Linderman Drill**  
From mesial to distal in a sweeping motion that runs from the mesial line angle to the distal line angle



➤ **No. 3 Diamond Bur**  
Removing the root apex and any gutta percha material in the apical portion



➤ **No. 4 Finishing Diamond Bur**  
The final preparation of the shaping and smoothing of the shield



➤ **No. 5 Final Shaper Bur**  
Used in the final preparation and reduction of the coronal portion



➤ **No. 6 Guided Chamfer Bur**  
In order to prepare the chamfer to the correct depth. Allows space for soft tissue to grow between the shield and the implant



**Dr. Howard Gluckman**



## Specially designed in collaboration with Dr. Howard Gluckman

The PET Kit, developed in collaboration with Dr. Howard Gluckman, provides the right tools for a predictable step-by-step PET process with more predictable results.

The strong point of Partial Extraction Therapy is that it guarantees a high success rate of immediate implant placement which leads to strong initial stability. AnyRidge® Implant system of MegaGen and Partial Extraction Therapy are in harmony with strong initial stability and fast osseointegration.

The biologically driven design of the AnyRidge® implant system & its unique XPEED surface treatment provides exceptional initial stability & rapid osseointegration. This makes the AnyRidge® implant the perfect match with Partial Extraction Therapy.



## How to Use Partial Extraction Therapy Kit

### ➤Socket Shield Technique

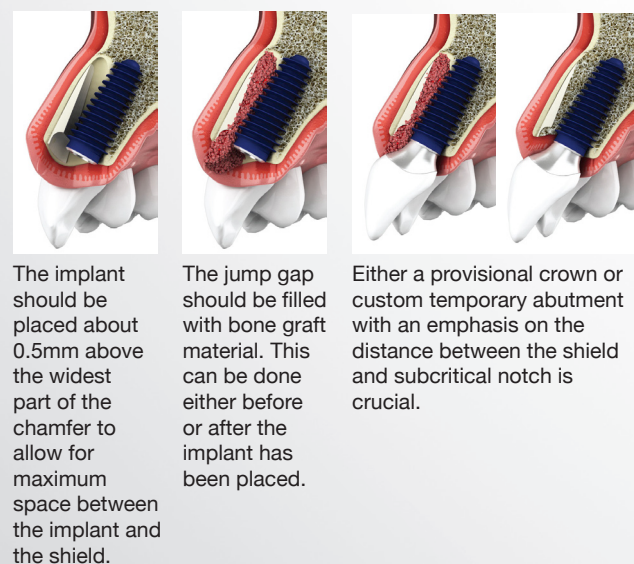
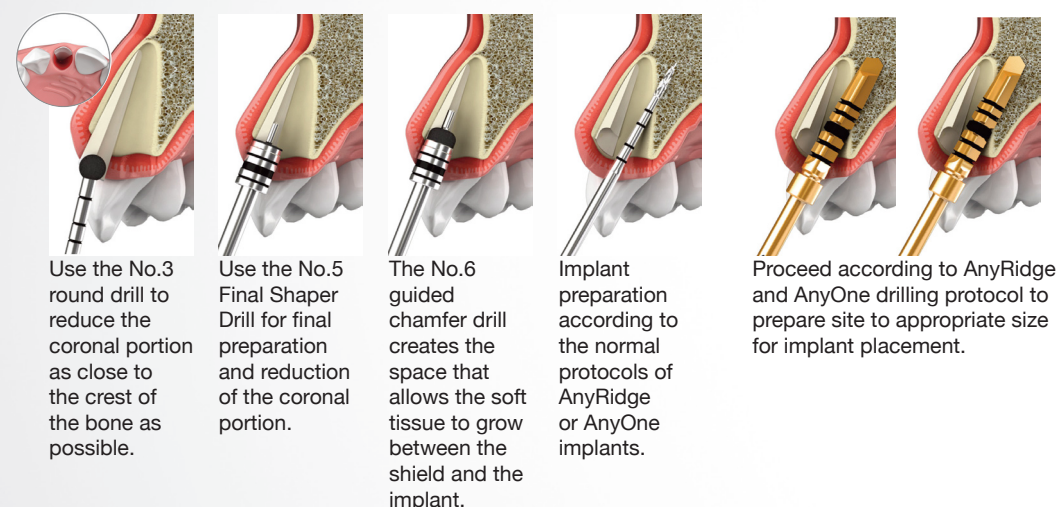
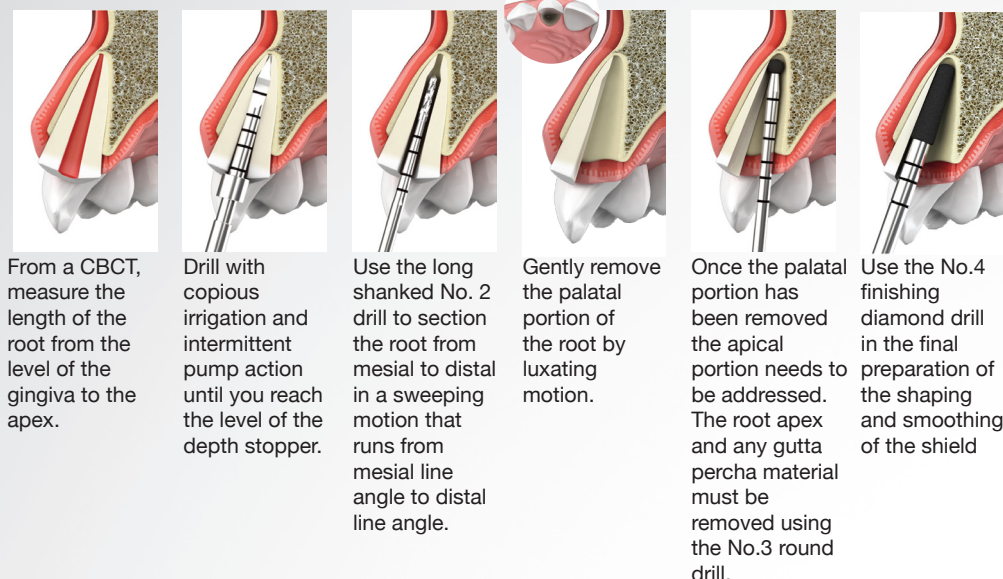

### ➤Pontic Shield Technique

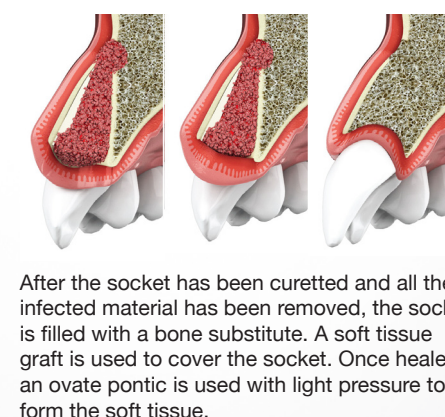
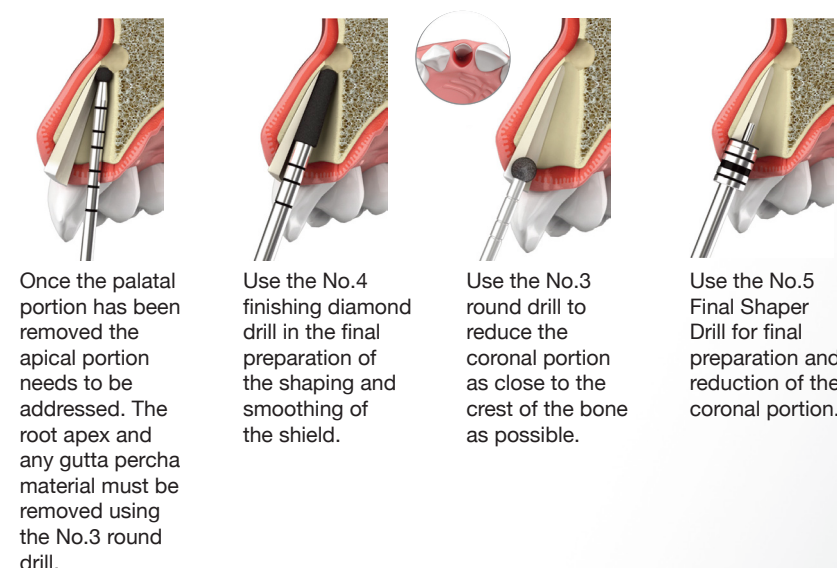
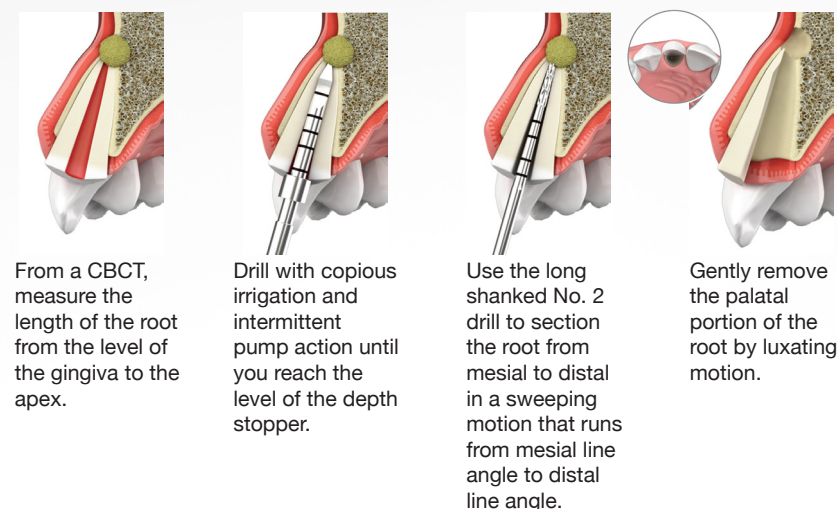

### ➤Root Submergence Technique

#### Vital Root Submergence

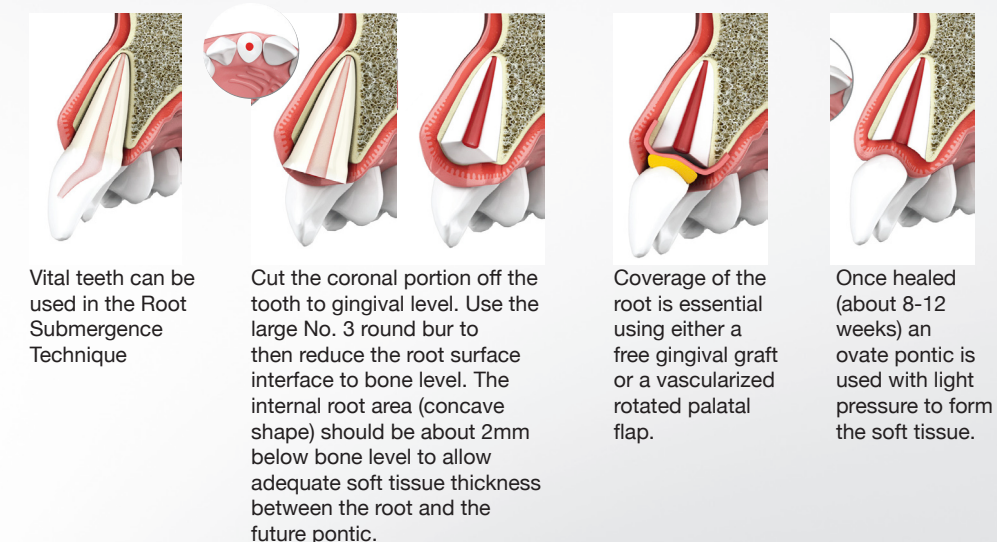

#### Non-vital Root Submergence

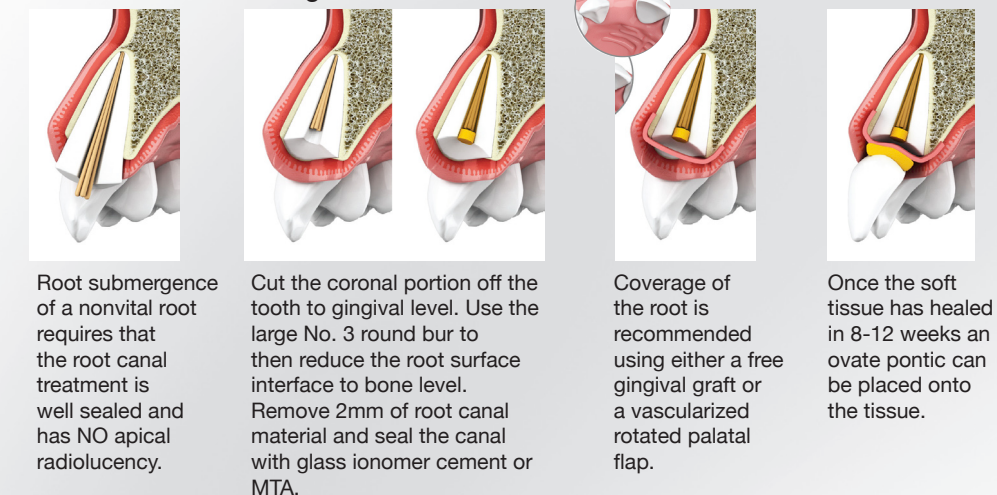

## Perfect Match with AnyRidge

#### AnyRidge Knife Thread Design

Knife Thread® with an oblique shape is designed of round face and narrow thread. Therefore, it can obtain an optimal ISQ because it is placed without damaging the unique architecture of cancellous bone. Also, it gives even stress distribution.

#### AnyRidge Xpeed® Surface Treatment

XPEED® surface treatment technology is that the Ca<sup>2+</sup> ions which increase osseointegration rate on fixture surface can be reached through the chemical reaction with 0.5 micrometer thickness. Also, there is no problem of absorption of the coating layer after scaling deterioration, BIC and Removal Torque values are excellent.

